

PRODUCT: CORNER POST BRACKET**REFERENCE:** TD-SH-10**shorehire.**Shore Hire Pty. Ltd.
PO Box CP449
354 Edgar Street
Condell Park
NSW 2200
Tel: 02 8708 1200
Fax: 02 8708 1222
Email: info@shorehire.com.au
Web: www.shorehire.com.au

TECHNICAL DATA

Description

The Shore hire corner post system is used where a four sided shoring setup is required. The corner post system is compatible with Shore hire 4M-60 Trench boxes Upper Panels only and is limited to a rated capacity of panel of 30kPa.

This four sided corner post setup is extremely robust. Each individual corner post spigot bracket weighs 98kg. A pair of corner bracket connects spigots of 2 Upper panels. 2 pairs of corner brackets are required for each corner to connect Upper panels using 2 spigots.

All the corner post brackets combined to form a 4 sided panel trench box will add significant weight to the over all setup. Thus, a large excavator or in some scenarios a crane may be required to install and remove this shoring solution.



Corner Post Bracket Assembly with 4M-60 Upper Panels

PRODUCT: CORNER POST BRACKET

REFERENCE: TD-SH-10

shorehire.

Shore Hire Pty. Ltd.
 PO Box CP449
 354 Edgar Street
 Condell Park
 NSW 2200
 Tel: 02 8708 1200
 Fax: 02 8708 1222
 Email: info@shorehire.com.au
 Web: www.shorehire.com.au

TECHNICAL DATA

Corner Post Bracket

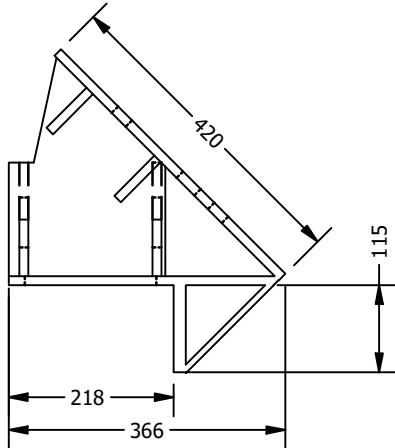

Top View

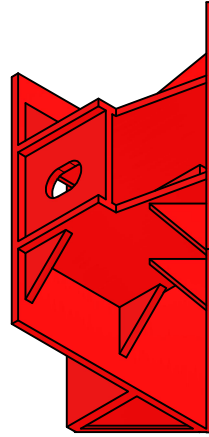

Isometric View

4M-60 UPPER PANEL CORNER POST BRACKET

1. All dimensions in mm U.N.O.
2. Steel material to be manufactured to AS 3679 & a minimum grade 350 U.N.O.
3. Compatible with Strut 168 Pin & Clip Connection.
4. Each pair of brackets fitment require:
 4 x M24 GRADE 8.8 B.N.W
 2 x M30 GRADE 8.8 B.N.W
5. Unit weight of bracket is 98 kg.

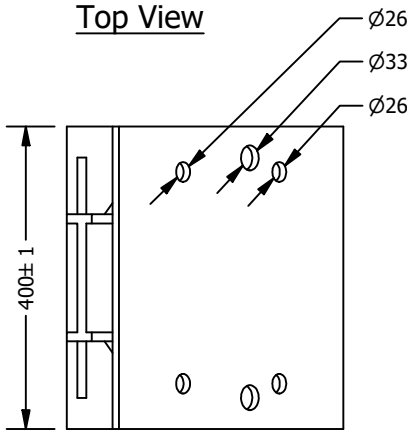

Front View

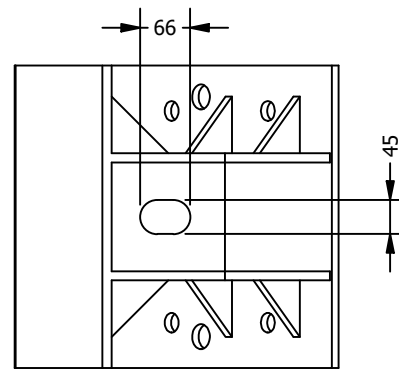

Side View

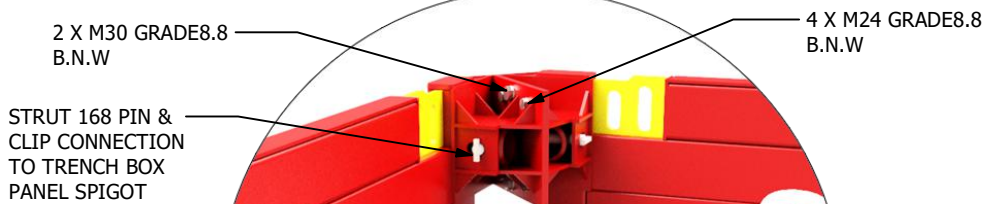

Corner Post Fitment

PRODUCT: CORNER POST BRACKET
REFERENCE: TD-SH-10

shorehire.

Shore Hire Pty. Ltd.
 PO Box CP449
 354 Edgar Street
 Condell Park
 NSW 2200
 Tel: 02 8708 1200
 Fax: 02 8708 1222
 Email: info@shorehire.com.au
 Web: www.shorehire.com.au

TECHNICAL DATA

Four Sided Shoring Setup Arrangement with 4M-60 Trench Box Upper Panels

4M-60 UPPER PANEL CORNER POST BRACKET

SHORING ARRANGEMENT				
WLL	X-DIRECTION	Y-DIRECTION	QUANTITY OF CORNER BRACKETS	TOTAL WEIGHT (KG)
30 kPa	4M-60	4M-60	8	6088

1. All dimensions in mm U.N.O.
2. Steel material to be manufactured to AS 3679 & a minimum grade 350 U.N.O.
3. Compatible with Strut 168 Pin & Clip Connection.
4. Each pair of brackets fitment require:
 4 x M24 GRADE 8.8 B.N.W
 2 x M30 GRADE 8.8 B.N.W
5. Unit weight of bracket is 98 kg.

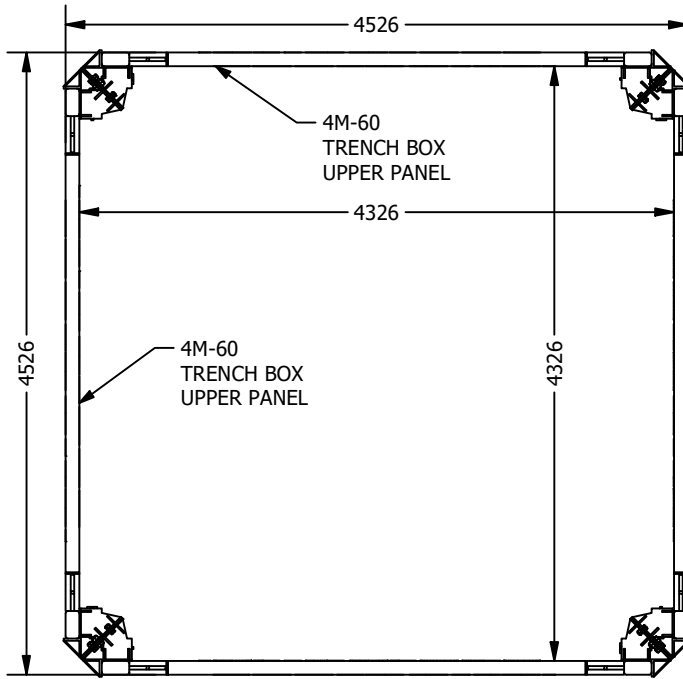

ASSEMBLY-TOP VIEW

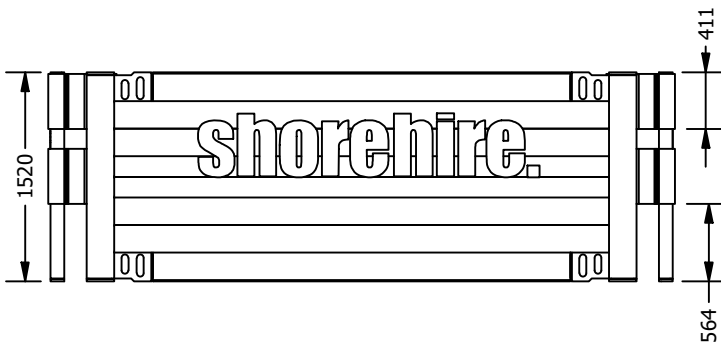

**ASSEMBLY-ELEVATION VIEW
 OPTION-SINGLE STACK**

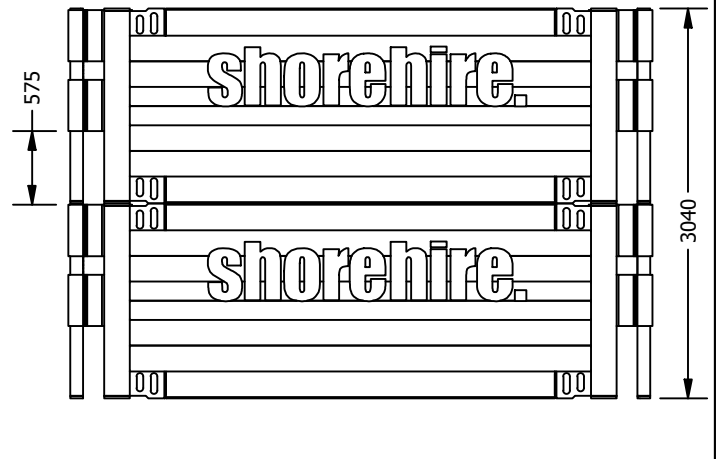

**ASSEMBLY-ELEVATION VIEW
 OPTION-DOUBLE STACK**